

**OPERATING INSTRUCTIONS  
FOR  
KLEIN CATALOG NOS.: 57040 & 57041  
HEX. DRIVE RATCHET TORQUE WRENCHES**

**NOTE:**

This product operates in one direction only. ALWAYS APPLY TORQUE IN THE DIRECTION OF THE ARROW ON THE CASE (1). However, tool can be used to loosen a fastener in opposite direction of the arrow, provided that the rated torque capacity of the tool is not exceeded.

1. Operator must adjust tool to proper torque setting. Unlock grip lock (2) by turning in the clockwise direction (an arrow and UNLOCK are engraved on the grip lock (2)). The case (1) is engraved with the torque unit of measure (inch lbs) and the large graduations (50, 80, 150, etc.) of torque values that the tool can be adjusted to. The grip (3) is engraved with the smaller graduations. Every 10 graduations on the grip (1 revolution) is equal to 1 graduation on the case (1). Rotate rubber handle (4) clockwise to increase or counterclockwise to decrease the torque setting, until desired setting is reached on the case (1) and grip (3) scales.
2. Insert appropriate hex. bit into the 7/16" female ratcheting hex. drive (5). To apply torque, pull in the direction of the arrow on the case (1). Ratchet easily reverses direction by simply pushing the reversing pin (6) to the right for CCW ratcheting and to the left for CW ratcheting.
3. Grip rubber handle firmly and pull slowly and steadily in direction of arrow until operator hears and feels "click". STOP PULLING IMMEDIATELY to prevent over-torque of fastener. Wrench automatically resets itself upon release of torque load and is ready for next application.

**NOTE:**

Always store tool with torque graduation set to the lowest setting.

DO NOT ATTEMPT TO RECALIBRATE TOOL WITHOUT FACTORY INSTRUCTIONS!!! Should repair and/or re-calibration become necessary, we recommend that the torque wrench be returned to KLEIN TOOLS INC. for service.

**KLEIN CATALOG NO.: 57040**

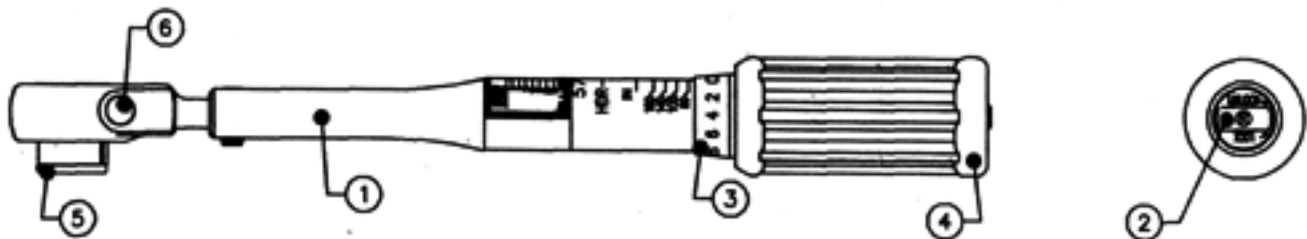

**KLEIN CATALOG NO.: 57041**

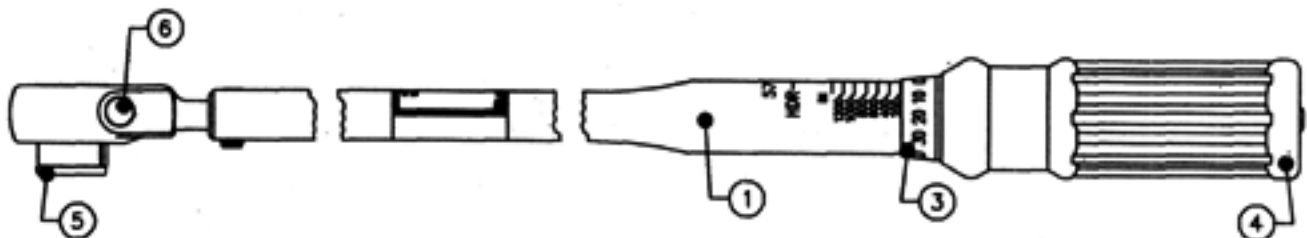

**OPERATING INSTRUCTIONS  
FOR  
KLEIN CATALOG NO.: 57035  
TORQUE LIMITING SCREWDRIVER**

**NOTE:**

This product limits torque in either right or left-hand direction of rotation. The tool can also be used to loosen a fastener, provided that the rated torque capacity of the tool is not exceeded.

1. Unless otherwise specified, the model 57035 screwdriver is shipped with the torque graduation set to the lowest setting. This setting is read by looking through the plastic lens (1) and observing that the hairline on the lens (1) is aligned with the cross line on the screwdriver shaft (2).
2. The torque adjusting key (3) is located at the back end of the handle (4). Lift the key (3) to vertical position and turn to the right (clockwise) to increase the torque setting, to the left (counter-clockwise) to decrease. When the black hairline on the lens (1) is aligned with the desired setting, push the key (3) back to the flat position. A very slight movement of the key (3) may be necessary in order that the projection on the key (3) will fit into one of the locking slots on the handle (4). This serves to lock the setting for normal use. If a more permanent or tamper-proof setting is desired, insert the enclosed self tapping screw (5) through the hole in the key (3) into the corresponding hole in the handle (4). The Phillips recess in the screw (5) head may be filled with sealing wax or fusible alloy for additional protection.
3. These screwdrivers do not require periodic lubrication.
4. The shaft (2) on the screwdriver has a 1/4" female hex opening for any one of many commercial type, 1/4" male hex insert bits.

**NOTE:**

Always store tool with torque graduation set to the lowest setting.

**DO NOT ATTEMPT TO RECALIBRATE TOOL WITHOUT FACTORY INSTRUCTIONS!!!** Should repair and/or re-calibration become necessary, we recommend that the torque wrench be returned to KLEIN TOOLS INC. for service.

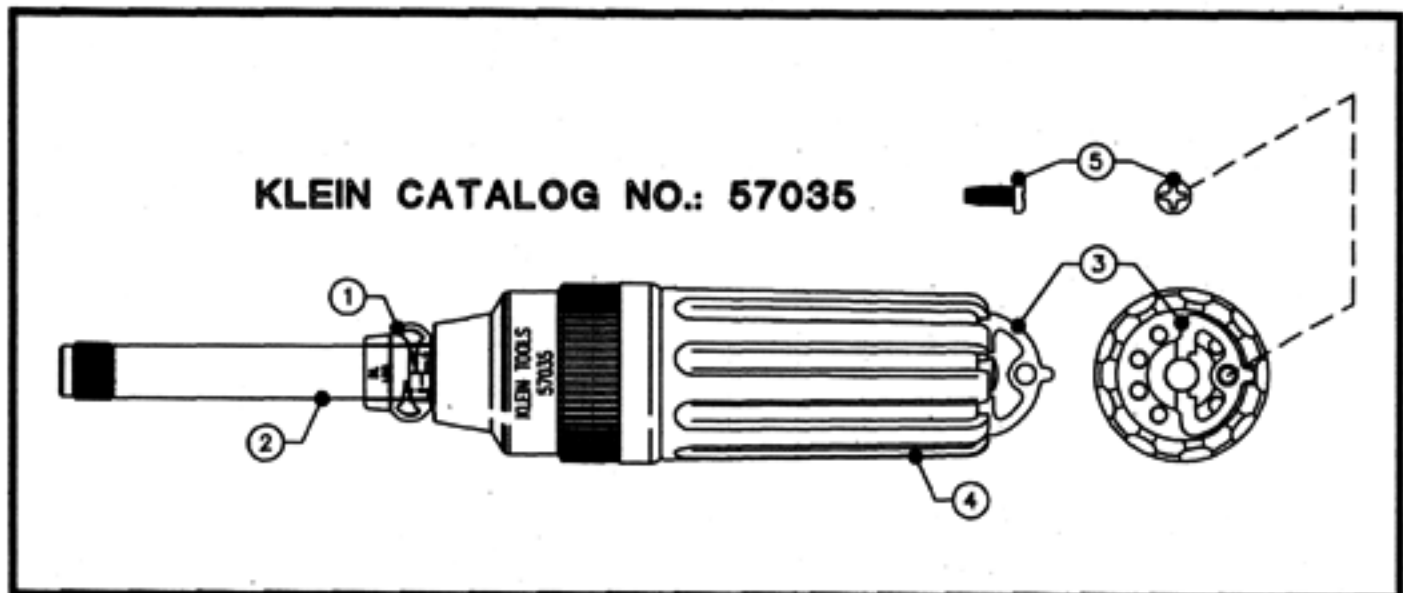

SEND REPAIRS TO: Klein Tools, Inc.  
3203 North Wolf Road  
Franklin Park, IL 60131-1326

**LIFETIME WARRANTY:** See retailer or visit [www.kleintools.com](http://www.kleintools.com) for details.

**KLEIN TOOLS**

857194